

KÄRCHER

makes a difference

SC 3 EasyFix
SC 3 EasyFix Premium

English 5
中文 15



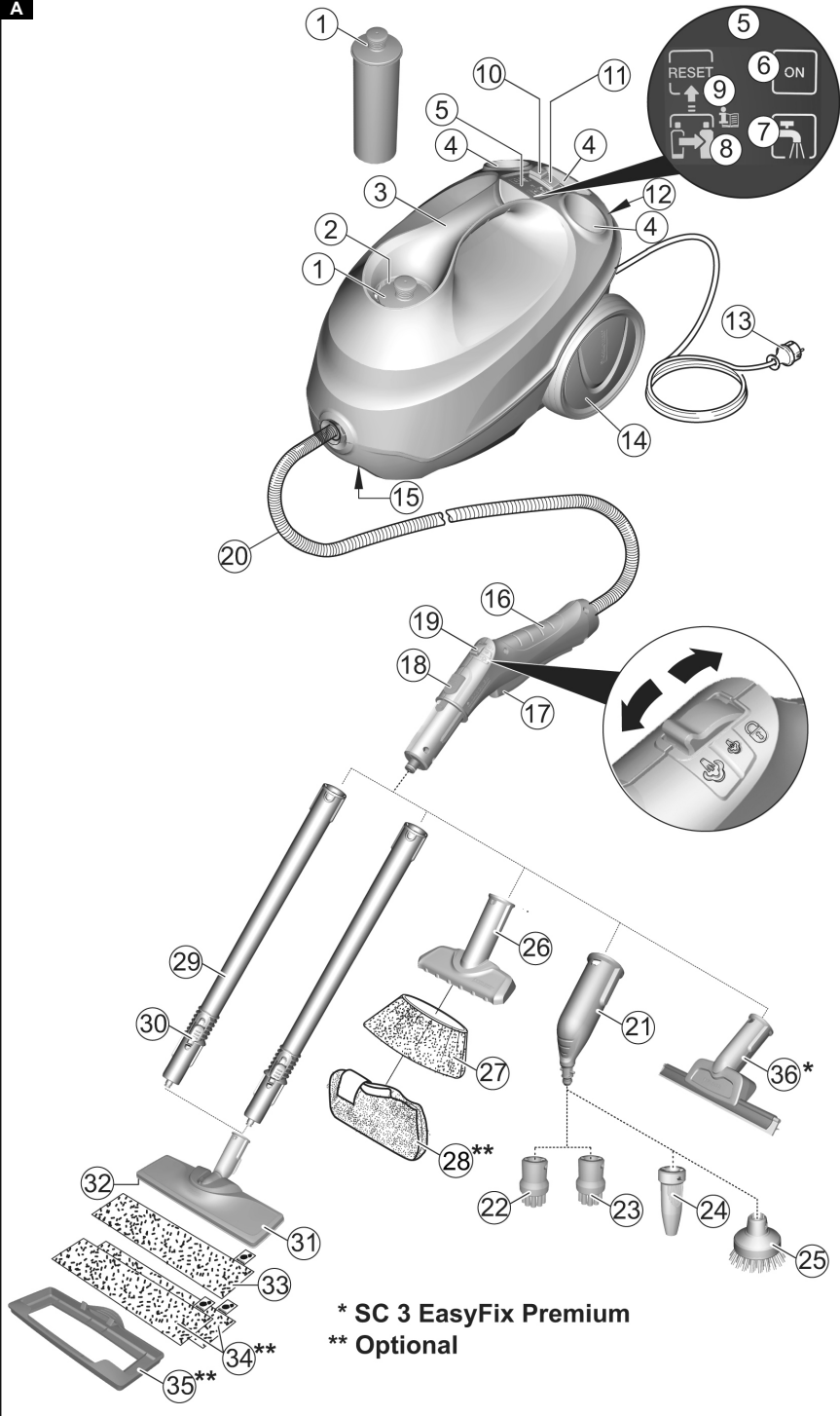

* SC 3 EasyFix Premium
** Optional

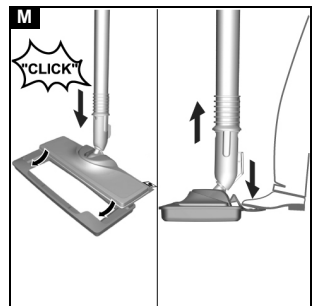
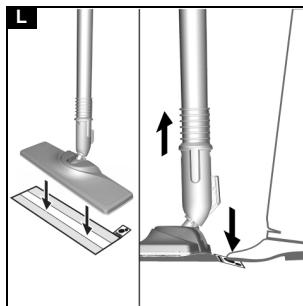
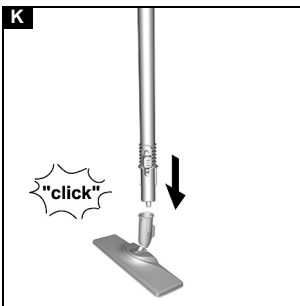
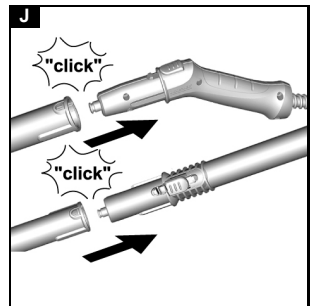
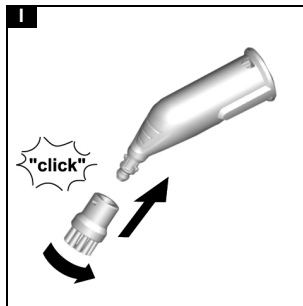
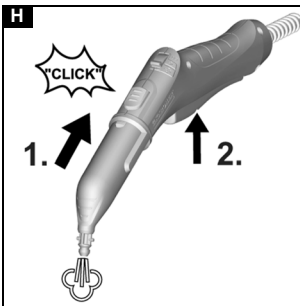
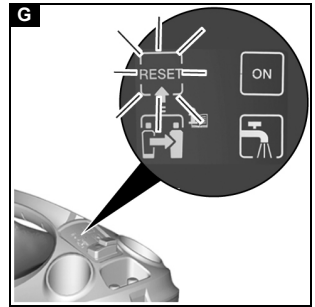
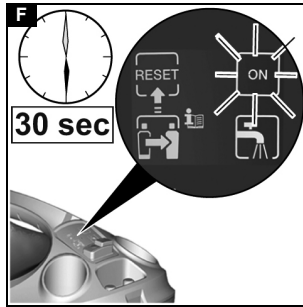
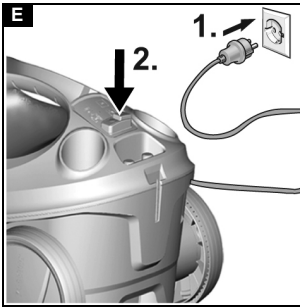
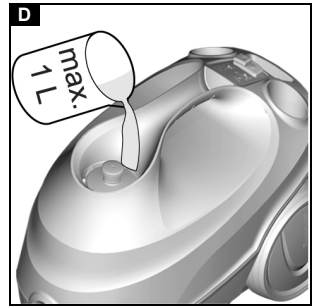
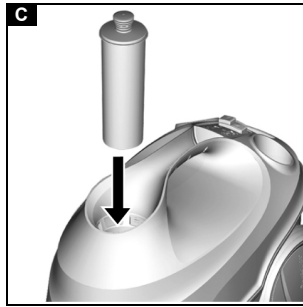
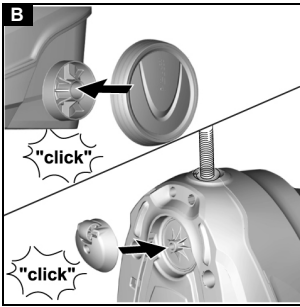

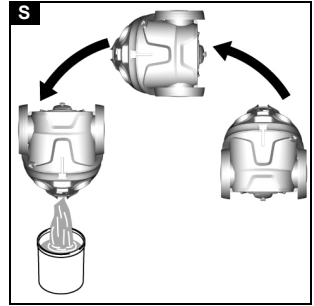
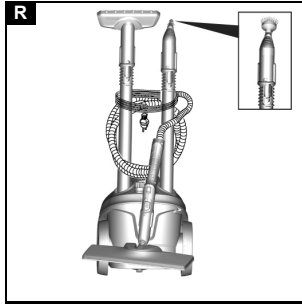
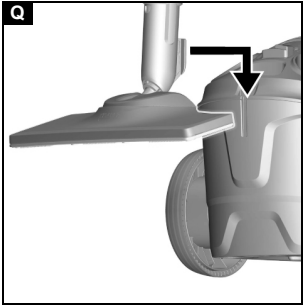
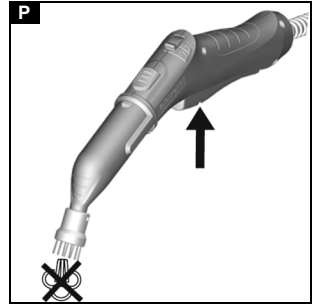
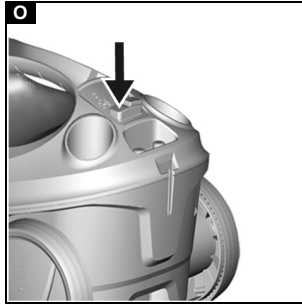
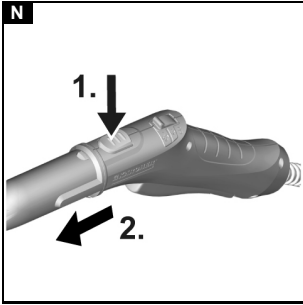

Safety instructions Steam cleaner

- You also need to take into consideration the general safety regulations and accident prevention guidelines of the legislator in addition to the notes in the operating instructions.
- Warnings and information notices attached to the device provide important information for hazard-free operation.

Hazard levels

△ DANGER

Indication of an imminent threat of danger that will lead to severe injuries or even death.

△ WARNING

Indication of a potentially dangerous situation that may lead to severe injuries or even death.

△ CAUTION

Indication of a potentially dangerous situation that may lead to minor injuries.

ATTENTION

Indication of a potentially dangerous situation that may lead to damage to property.

General safety notes

△ DANGER ● *Risk of asphyxiation. Keep packaging film out of the reach of children.*

△ WARNING ● *Only use the device for its proper use. Take into account the local conditions and beware of third parties, in*

particular children, when working with the device. ● Only people who have been instructed on how to use the device, or have proven their ability to operate it, and have been explicitly instructed to use it, must use the device. ● Persons with reduced physical, sensory or mental capabilities, or those with a lack of experience and knowledge, are only allowed to use the appliance if they are supervised or have been instructed with respect to using the appliance safely, and understand the resultant dangers involved. ● Children must not operate the device. ● Children must be supervised to prevent them from playing with the appliance. ● Keep the device out of the reach of children while it is switched on and as long as it has not cooled down.

△ CAUTION ● *Do not use the device if it has been dropped beforehand, is visibly damaged or if it is leaking. ● Safety devices are provided for your own protection. Never modify or bypass safety devices.*

Risk of electric shock

△ DANGER ● *Never touch the mains plug and socket with wet hands. ● Only connect the device to alternating current. The voltage indicated on the type*

plate must match the voltage of the power source. ●Do not direct the steam jet directly onto equipment containing electrical components, e.g. the interior space of ovens. ●Do not fill the devices with removable water reservoir directly via the water connection while they are connected to the mains power. Use a receptacle for filling. ●Do not use the device in swimming pools which contain water. ●The mains plug and extension cable connection must not be in water. **△ WARNING** ●Only connect the device to an electrical connection which has been set up by a qualified electrician as per IEC 60364-1. ●Only operate the device in wet rooms, e.g. bath-room, connected to sockets with upstream residual current device. ●Check the power supply cable with mains plug for damage before operation each time. Do not put the device into operation with a damaged power supply cable. Have a damaged power supply cable replaced immediately by the authorised customer service / qualified electrician. ●Do not damage the power supply and extension cable by running over it, crushing or yanking it or similar. Protect the power supply cable from heat, oil and sharp edges. ●Unsuitable electrical extension ca-

bles can be dangerous. Only use electrical extension cables with a splash guard and a diameter of at least $3 \times 1 \text{ mm}^2$. ●Only replace couplings on the power supply or extension cable with those with the same splash guard and the same mechanical strength. ●Clean tiled walls with sockets carefully.

△ CAUTION ●In case of longer breaks in operation and after use, switch off the device at the main switch / device switch and pull the mains plug.

Operation

△ DANGER ●Operation in explosive atmospheres is prohibited. ●When using the device in hazard zones (e.g. service stations), adhere to the respective safety regulations.

△ WARNING ●Risk of scalding. Never touch the steam jet with your hand from a close distance, and do not direct it at people or animals. ●Risk of scalding from high water output if you tilt the due to more than 30° to the side when using it.

Applies to SC 1 devices only

● Risk of scalding on the hot steam boiler. Allow the steam boiler to cool down before filling it with water.

Does not apply to SC 3 devices

● *Never disconnect accessories from the device while steam is being expelled. ● Hot water may drip out when disconnecting accessory parts. Allow the device to cool down first. ● Never open the maintenance / safety lock during operation. Allow the device to cool down first. ● Do not clamp the steam lever / steam key during operation. ● Replace a damaged steam hose immediately with a steam hose as recommended by the manufacturer. ● Do not steam any objects which contain harmful substances (e.g. asbestos).*

△ **CAUTION** ● *Only operate or store the device in accordance with the description or figure. ● Check the device and the accessories, in particular the power supply cable, safety lock and steam hose, to make sure it is in proper safe and reliable condition before operation each time. Do not use the device if it is damaged. Replace damaged components immediately. ● Only switch on the device when water is present in the steam boiler. The device may otherwise overheat, see chapter Troubleshooting. ● Accidents or damage due to the device falling over. Before all actions with or on the device, you must make sure that it is stable.*

ATTENTION ● *Do not fill with any cleaning agents or other supplements. ● Do not operate the device at temperatures below 0 °C. ● Never leave the device unsupervised while it is in operation. ● Protect the device from rain. Do not store the device outdoors. ● Device damage. Never pour solvents, liquids which contain solvents or diluted acids (e.g. cleaning agent, petrol, paint thinner and acetone) into the boiler / water reservoir.*

For upright machines

△ **CAUTION** ● *In order to guarantee stability, place the device on a firm, flat surface. ● Do not carry the device when performing cleaning work.*

Care and service

△ **WARNING** ● *Only carry out servicing work when the mains plug is pulled and the steam cleaner has cooled down.*

△ **CAUTION** ● *Have repair work carried out by the authorised customer service only.*

Contents

General notes	8
Intended use	8
Environmental protection	8
Accessories and spare parts	8
Scope of delivery	8
Warranty	8
Safety devices	8
Description of the unit	8
Initial start-up	9
Installation	9
Operation	9
Important application instructions	10
How to use the Accessories	10
Care and service	12
Troubleshooting guide	13
Technical data	14

General notes



Please read and comply with these original instructions prior to the initial operation of your appliance and store them for later use or subsequent owners.

Intended use

Only use the appliance in private households. The appliance is intended for cleaning with steam and can be used with appropriate accessories as described in these operating instructions. Detergents are not required. Observe the safety instructions.

Environmental protection



The packing materials can be recycled. Please dispose of packaging in accordance with the environmental regulations.



Electrical and electronic appliances contain valuable, recyclable materials and often components such as batteries, rechargeable batteries or oil, which - if handled or disposed of incorrectly - can pose a potential threat to human health and the environment. However, these components are required for the correct operation of the appliance. Appliances marked by this symbol are not allowed to be disposed of together with the household rubbish.

Notes on the content materials (REACH)

Current information on content materials can be found at: www.kaercher.com/REACH

Accessories and spare parts

Only use original accessories and original spare parts. They ensure that the appliance will run fault-free and safely.

Information on accessories and spare parts can be found at www.kaercher.com.

Scope of delivery

The scope of delivery for the appliance is shown on the packaging. Check the contents for completeness when unpacking. If any accessories are missing or in the event of any shipping damage, please notify your dealer.

Warranty

The warranty conditions issued by our relevant sales company apply in all countries. We shall remedy possible malfunctions on your appliance within the warranty period free of cost, provided that a material or manufacturing defect is the cause. In a warranty case, please contact your dealer (with the purchase receipt) or the next authorised customer service site. (See overleaf for the address)

Safety devices

⚠ CAUTION

Missing or modified safety devices

Safety devices are provided for your own protection.

Never modify or bypass safety devices.

Symbols on the appliance

(according to type of appliance)

	Risk of burns, surface of appliance becomes hot during operation
	Risk of scalding from steam
	Read operating instructions

Pressure controller

In case of inadmissibly high pressure in the event of a fault, a safety valve relieves the pressure into the atmosphere.

Fuse

The fuse prevents the device from overheating. If the device overheats, the fuse disconnects the device from the power supply.

Before re-commissioning the device, contact the responsible KÄRCHER Customer Service.

Description of the unit

The maximum amount of equipment is described in these operating instructions. Depending on the model used, there are differences in the scope of delivery (see packaging).

For the illustrations, refer to the graphics page.

Illustration A

- ① Decalcification cartridge
- ② Filling hole for water
- ③ Carrying handle
- ④ Holder for accessories
- ⑤ Display
- ⑥ Indicator light (green) - mains voltage present
- ⑦ Indicator light (red) - fuse shortage
- ⑧ Indicator light (red) - replace decalcification cartridge.
- ⑨ RESET button - set water hardness.
- ⑩ Switch - On
- ⑪ Switch - Off
- ⑫ Park bracket for floor nozzle
- ⑬ Mains connection cable with mains plug

- ⑭ Non-driven wheels (2 x)
- ⑮ Steering roller
- ⑯ Steam gun
- ⑰ Steam lever
- ⑱ Unlocking button
- ⑲ Selector switch for steam volume (child lock)
- ⑳ Steam hose
- ㉑ Spotlight nozzle
- ㉒ Round brush (small, black)
- ㉓ Round brush (small, yellow)
- ㉔ Power nozzle
- ㉕ Round brush (large)
- ㉖ Manual nozzle
- ㉗ Microfibre cover for manual nozzle
- ㉘ ** Microfibre abrasive cloth for manual nozzle
- ㉙ Extension tubes (2 x)
- ㉚ Unlocking button
- ㉛ Floor nozzle
- ㉜ Hook and loop fastener
- ㉝ Microfibre floor cloth (1 x)
- ㉞ ** Microfibre floor cloth (2 x)
- ㉟ ** Carpet glider
- ㊱ * Window nozzle

* SC 3 EasyFix Premium

** optional

Initial start-up

ATTENTION

Device damage due to calcification

The decalcification cartridge only works properly if you adjust the device to the local water hardness before operating it for the first time.

Set the device to the local water hardness.

Set the device to the current water hardness before using it in an area with a different water hardness (e.g. after a move)

1. Insert the decalcification cartridge into the opening and push it so that it is firmly in place.

Illustration C

2. Set the water hardness, see chapter Setting the water hardness.

Installation

Installing accessories

1. Insert and engage the steering roller and non-driven wheels.

Illustration B

2. Push the open end of the accessory onto the steam gun so that the unlocking button on the steam gun engages.

Illustration H

3. Push the open end of the accessory onto the spotlight nozzle.

Illustration I

4. Connect the extension tubes with the steam gun.

- a Push the first extension tube onto the steam gun so that the unlocking button on the steam gun engages.
The connection pipe is connected.
- b Push the second extension tube onto the first extension tube.
The connection pipes are connected.

Illustration J

5. Push the accessory and / or the floor nozzle onto the free end of the extension tube.

Illustration K

The accessory is connected.

Disconnecting accessories

1. Set the selector switch for the steam volume to the rear.
The steam lever is locked.
2. Push the unlocking button and pull the parts apart.

Illustration N

Operation

Filling water

The water reservoir can be filled at any time.

ATTENTION

Damage to the device

Unsuitable water can block the nozzles or damage the water level indicator.

Do not use condensation from the clothes dryer for filling.

Do not use collected rain water for filling.

Do not use cleaning agents or other additives (e.g. scents) for filling.

1. Fill the water reservoir with a maximum of 1 l of tap water.

Illustration D

Switch on the device

ATTENTION

Device damage due to incorrectly set water hardness

The decalcification cartridge only works properly if the device is adjusted to the local water hardness. The device may calcify if the water hardness is set incorrectly. Adjust the device to the local water hardness before first operation, see chapter Setting the water hardness.

Note

When steaming for the first time after removing and re-inserting the decalcification cartridge, the steam jet may be weak or irregular, and individual drops of water may be expelled. The device requires a short running-in period in which the decalcification cartridge fills with water. The steam volume that is expelled increases constantly until the maximum steam volume has been reached after approx. 30 seconds.

1. Place the device on a firm surface.
2. Connect the mains plug into a socket to a socket.
 - a Press the On switch.



Illustration E

3. The green indicator light lights up.
The device is ready for use after approximately 30 seconds.

Illustration F

Regulating the steam volume

The expelled steam volume is regulated using the selector switch for steam volume. The selector switch has 3 positions:

	Maximum steam volume
	Reduced steam volume
	No steam - child lock Note <i>In this position, the steam lever cannot be operated.</i>

1. Set the selector switch for the steam volume to required steam volume.
2. Press the steam lever.
3. Before starting cleaning, point the steam gun at a cloth until steam is expelled evenly.

Topping up the water

If there is a water shortage, the red water shortage indicator light lights up constantly. For constant steam output, the water has to be topped up through the cover of the decalcification cartridge. When topping up the water, the decalcification cartridge remains secured in the device.

Note

The device is equipped with dry-run protection for the pump. If the pump runs dry for a longer period, e.g. because the decalcification cartridge is not correctly inserted, the pump switches off and the red water shortage indicator light flashes.

To be able to operate the device again, the device has to be switched off and back on again. In the process, you must make sure that the cartridge has been inserted correctly and there is enough water in the water reservoir.

1. Fill the water reservoir with a maximum of 1 l of tap water through the cover of the decalcification cartridge.
The red water shortage indicator light goes out.

Interrupting operation

In order to save energy, we recommend that you switch off the device for breaks in operation of longer than 20 minutes.

1. Press the Off switch.

Switching off the device

1. Press the Off switch.
Illustration O
The device has been switched off.
2. Press the steam lever until no more steam flows out.
Illustration P
The steam boiler is depressurised.
3. Set the child lock (selector switch for steam volume) to the rear.
The steam lever is locked.
4. Pull the mains plug from the socket.

ATTENTION

Device damage due to water putrefaction

If the device is not put into operation for more than 2 months, the water in the reservoir may putrefy.

Drain the water reservoir before breaks in operation.

5. Drain the water reservoir.

Illustration S

Storing the device

1. Connect the extension tubes to the large mounts for accessories.
2. Connect a manual nozzle and spotlight nozzle to each extension tube.
3. Fasten the large round brush to the spotlight nozzle.
4. Connect the small round brush and nozzles to the medium-sized mount for accessories.
5. Hang the floor nozzle in the park bracket.
Illustration Q
6. Wind the steam hose around the extension tube and connect the steam gun to the floor nozzle.
Illustration R
7. Wind the mains cable around the extension tube.
8. Store the device in a dry location that is protected from frost.

Important application instructions

Cleaning the floor areas

We recommend sweeping the floor or vacuum cleaning it before using the appliance. In this way the floor will be cleared of dirt and loose particles before the wet cleaning.

Freshening up textiles

Prior to using the appliance, always check the compatibility of the textiles at a concealed point: Steam down the textile, allow it to dry and then check it for any change in colour or shape.

Cleaning coated or painted surfaces

ATTENTION

Damaged surfaces

Steam can loosen wax, furniture polish, plastic coatings or paint and edge band from edges.

Do not direct the steam at glued laminated edges as the edge band may loosen.

Do not use the appliance for cleaning unsealed wood or parquet floors.

Do not use the appliance for cleaning painted or plastic coated surfaces such as kitchen or living room furniture, doors or parquet.

1. To clean these surfaces, steam a cloth briefly and use it to wipe over the surfaces.

Glass cleaner

ATTENTION

Glass breakages and damaged surfaces

Steam can damage sealed points of the window frame and, at low outside temperatures, lead to tension on the surface of window panes and hence to glass breakages. Do not direct the steam at sealed points on the window frame.

At low outside temperatures, heat up the window panes by gently steaming the full surface of the glass.

- Clean the window area with a manual nozzle and cover. To remove the water, use a squeegee or wipe the surfaces dry.

How to use the Accessories

Steam gun

The steam gun can be used for the following applications without accessories:

- For removing slight creases from the hanging clothing items: Steam the clothing item from a distance of 10-20 cm.
- For wiping damp dust: Steam a cloth briefly and use it to wipe over the furniture.

Spotlight nozzle

The spotlight nozzle is suitable for cleaning areas, joins, fittings, drains, sinks, WCs, blinds or radiators that are difficult to access. The closer the spotlight nozzle is to the soiled area, the greater the cleaning efficiency will be as the temperature and steam volume are at their highest at the nozzle opening. Larger lime deposits can be treated before steam cleaning with a suitable detergent. Allow the detergent to soak in for approx. 5 minutes and then steam it off.

1. Slide the spotlight nozzle onto the steam gun.

Illustration H

Round brush (small)

The small round brush is used for cleaning stubborn dirt. Stubborn dirt can be removed more easily by brushing.

ATTENTION

Damaged surfaces

The brush may scratch sensitive surfaces.

It is not suitable for cleaning sensitive surfaces.

1. Fit the round brush to the spotlight nozzle.

Illustration I

Round brush (large)

The large round brush is suitable for cleaning large rounded surfaces, e.g. wash basin, shower tray, bath tub, kitchen sink.

ATTENTION

Damaged surfaces

The brush may scratch sensitive surfaces.

It is not suitable for cleaning sensitive surfaces.

1. Fit the large round brush to the spotlight nozzle.

Illustration I

Power nozzle

The power nozzle is used for cleaning stubborn dirt, blowing down corners, joins etc.

1. Install the power nozzle onto the spotlight nozzle according to the round brush.

Illustration I

Manual nozzle

The manual nozzle is used for cleaning small areas that can be washed down, shower cubicles and mirrors.

1. Push the manual nozzle onto the steam gun according to the spotlight nozzle.

Illustration H

2. Pull the cover over the manual nozzle.

Window nozzle

For easy and thorough cleaning of glass, windows or mirrors.

By the steam outlet opening takes place uniform steaming of glass panes.

1. Push the window nozzle onto the steam gun according to the spotlight nozzle.

Illustration H

2. Use the rubber lip of the nozzle to pull the glass surfaces from the top to the bottom.

3. Wipe the rubber lip the bottom edge of the window with a dry cloth after each strip.

Floor nozzle

The floor nozzle is used for cleaning washable wall and floor coverings e.g. stone floors, tiles and PVC floors.

ATTENTION

Damage due to build-up of steam

Heat and moisture can lead to damage.

Check the heat resistance and steam effect on an inconspicuous area using a minimal volume of steam prior to use.

Note

Detergent residue or care emulsions on the surface to be cleaned can lead to streaks during steam cleaning, which will disappear however once these have been used several times.

We recommend sweeping the floor or vacuum cleaning it before using the device. In this way the floor will be cleared of dirt and loose particles before the wet cleaning commences. Work slowly on surfaces that are heavily soiled so that the steam has longer to take effect.

1. Connect the extension tubes with the steam gun.

Illustration J

2. Push the floor nozzle onto the extension tube.

Illustration K

3. Fasten the floor cleaning cloth to the floor nozzle.
 - a Place the floor cleaning cloth with the hook and loop fastener strips pointing upwards on the floor.
 - b Place the floor nozzle onto the floor cleaning cloth, applying slight pressure.

Illustration L

The floor cleaning cloth will stick to the floor nozzle of its own accord due to the hook and loop fastener.

Removing the floor cleaning cloth

1. Place one foot on the bottom corner of the floor cleaning cloth and lift the floor nozzle up.

Illustration L

Note

Initially, the floor cleaning cloth's hook and loop fastener strip is very strong and cannot be removed from the floor nozzle easily. After the floor cleaning cloth has been used several times and washed, it is easier to remove from the floor nozzle and it has reached the optimum adhesion.

Parking the floor nozzle

1. Hang the floor nozzle in the park bracket during breaks in work.

Illustration Q

Carpet glider

The carpet glider is used for freshening up carpets.

ATTENTION

Beware of damaging the carpet glider and carpet

Contamination on the carpet glider, as well as heat and moisture penetration, can result in the carpet being damaged.

Prior to the application, also check the heat resistance and impact of steam on the carpet at an insignificant spot using as small an amount of steam as possible. Observe the cleaning instructions from the carpet manufacturer.

Prior to using the carpet glider, make sure that the carpet has been vacuumed and that stains have been removed.

Prior to application and following operating pauses, remove any possible water accumulation (condensate) in the appliance by means of evaporating the condensate into a drain (without floor cleaning cloth / with accessories).

Only use the carpet glider with a floor cleaning cloth on the floor nozzle.

Steam clean with a weak steam stage when using the carpet glider.

In order to prevent too much moistening and to avoid the risk of damage due to temperature effects, do not di-

rect the steam continuously onto one spot (maximum 5 seconds).

Do not use the carpet glider on deep-pile carpets.

Fastening the carpet glider to the floor nozzle

- For fastening the floor cleaning cloth to the floor nozzle, please refer to chapter Floor nozzle.
- Using a little force, allow the floor nozzle to slide into the carpet glider and engage there.
- Start cleaning the carpet.

Illustration L

Illustration M

Removing the carpet glider from the floor nozzle

⚠ CAUTION

Beware of burns to your feet

The carpet glider can heat up during the steaming process.

Do not operate or remove the carpet glider bare-footed or using open sandals.

Only operate or remove the carpet glider using suitable footwear.

- Press the strap on the carpet glider downwards using your toecap.
- Lift the floor nozzle upwards.

Illustration M

Care and service

Draining the water reservoir

ATTENTION

Device damage due to water putrefaction

If the device is not put into operation for more than 2 months, the water in the reservoir may putrefy.

Drain the water reservoir before breaks in operation.

- Press the Off switch.
The device has been switched off.
- Pull the mains plug out of the socket.
- Remove the accessories from the accessory holders.
- Remove the decalcification cartridge from the device.
- Drain the water reservoir.

Illustration S

Replacing the decalcification cartridge

ATTENTION

Device damage and shortened service life

If the replacement intervals (indicator light) for the decalcification cartridge are not observed, there is a risk of device damage and the service life of the device may be shortened.

Observe the replacement intervals (indicator light).

Note

The replacement intervals depends on the local water hardness. Areas with hard water (e.g. III/IV) have a higher replacement interval than areas with soft water (e.g. I/II).

Indicator lamp at end of the run time

The "decalcification cartridge indicator light" indicates when the decalcification cartridge has to be replaced:

- The indicator light flashes 2 hours before the run time expires.
- The indicator light flashes more quickly 1 hour before the run time expires.
- Once the run time for the decalcification cartridge has expired, the indicator light lights up constantly and the device switches off automatically in order to prevent device damage.

Inserting the decalcification cartridge

ATTENTION

Device damage

There is a risk of damage to the device if the used decalcification cartridge is re-used.

Work carefully in order to prevent mixing up the cartridges.

Note

When steaming for the first time after removing and reinserting the decalcification cartridge, the steam jet may be weak or irregular, and individual drops of water may be expelled. The device requires a short running-in period in which the decalcification cartridge fills with water. The steam volume that is expelled increases constantly until the maximum steam volume has been reached after approx. 30 seconds.

- Press the Off switch.
The device has been switched off.
- Remove the decalcification cartridge.
- Insert the new decalcification cartridge.
- Press the On switch.
The device is switched on.
- Press and hold the RESET key for 4 seconds.
The "replace decalcification cartridge" indicator light goes out and the run time for the decalcification cartridge starts again.
- Allow the device to heat up.
- Press and hold the steam lever for approximately 30 seconds to vent the decalcification cartridge.

Setting the water hardness

ATTENTION

Device damage due to calcification

Without a decalcification cartridge, the device may calcify if the water hardness is set incorrectly.

Always work with a decalcification cartridge.

Set the device to the local water hardness.

Set the device to the current water hardness before using it in an area with a different water hardness (e.g. after a move).

Note

Your water board or municipal utilities authority can provide information on hardness of tap water.

The water hardness is set using the RESET key. The water hardness setting is stored until a new setting (e.g. after a move) is made. The device is set to the highest water hardness (level IV) in the factory. The device indicates the set water hardness with flash pulses.

Water hardness levels and flash pulses

Hardness range	°dH	mmol/l	Number of flash pulses	Interval between flash pulses
I soft	0-7	0-1.3	1x	4 seconds
II Medium	7-14	1.3-2.5	2x	
III Hard	14-21	2.5-3.8	3x	
IV Very hard	>21	>3.8	4x	

Note

The anti-calcification effect of the decalcification cartridge is activated as soon as the device is filled with water and put into operation. Lime in the water is absorbed by the granulate in the decalcification cartridge. Additional descaling is not required.

Note

The granulate in the cartridge may change colour after it comes into contact with water. This depends on the mineral content in the water. This discolouration is harmless and does not have a negative effect on the device, cleaning work or the functionality of the decalcification cartridge.

Note

Do not pause for longer than 15 seconds when setting as the device will otherwise be set automatically to the last selected water hardness or the highest water hardness set during initial start-up.

1. Connect the mains plug.
2. Make sure that the device is switched off.
3. Press the RESET key and hold it while the device is switched on.

Illustration G

After approximately 2 seconds, the indicator light flashes and signals the current water hardness setting with the number of pulses.

4. Press the RESET key repeatedly to change the water hardness level.

Note

When the RESET key is pressed, the flash pulse for the water hardness level is not indicated.

5. Release the RESET key.
The flash pulse for the set water hardness is indicated.
6. Repeat the process as necessary until the desired water hardness level has been achieved.
7. Press and hold the RESET key for 3 seconds to save the setting for the water hardness level.
The indicator light for the water hardness lights up.

Care of accessories

(Accessories - depending on scope of delivery)

Note

The floor cleaning cloth and the cover for the manual nozzle have been washed beforehand and can be used immediately for working with the appliance. The micro fibre cloths are not suitable for dryer.

Note

When washing the cloths, observe the instructions on the washing tag. Do not use any liquid softeners as this will affect the ability of the cloths to pick up dirt.

1. Wash the floor cleaning cloths and covers at a max. temperature of 60 °C in the washing machine.

Troubleshooting guide

Malfunctions often have simple causes that you can remedy yourself using the following overview. When in doubt, or in the case of malfunctions not mentioned here, please contact your authorised Customer Service.

⚠ WARNING

Risk of electric shock and burns

Trying to eliminate faults while the appliance is connected to the mains or has not yet cooled down is always dangerous.

Remove the mains plug.

Allow the appliance to cool down.

The water shortage indicator light flashes red

The dry-run protection for the pump is deactivated.

1. Switch the device off and back on again.
2. Make sure that the decalcification cartridge has been inserted correctly and there is sufficient water in the reservoir.

The water shortage indicator light lights up constantly in red

No water in the water reservoir.

1. Top up the water reservoir, see chapter Topping up the water.

The steam lever cannot be pressed

The steam lever is locked with the child lock.

- Set the child lock (selector switch for steam volume) to the front.

The steam lever is released.

No / little steam although there is water in the reservoir

The decalcification cartridge has not been inserted or has been inserted incorrectly.

- Insert the decalcification cartridge or insert it correctly.

The decalcification cartridge has been removed while topping up the water.

- Leave the decalcification cartridge in the device when topping up.

New decalcification cartridge has been inserted.

- Press and hold the steam lever constantly.
The full steam output is reached after approximately 30 seconds.

Red indicator light "replace descaling cartridge" lights up / flashes

Run time of the decalcification cartridge ends soon.

- Insert the new decalcification cartridge and reset the maintenance indicator, see chapter Replacing the decalcification cartridge.

The RESET key was not pressed after replacement of the decalcification cartridge.

- Press and hold the RESET key for 4 seconds after inserting the decalcification cartridge, see chapter Replacing the decalcification cartridge.

Device switches off automatically

Run time for the decalcification cartridge has expired

- Insert the new decalcification cartridge and reset the maintenance indicator, see chapter Replacing the decalcification cartridge.

The RESET key was not pressed after replacement of the decalcification cartridge.

- Press and hold the RESET key for 4 seconds after inserting the decalcification cartridge, see chapter Replacing the decalcification cartridge.

Technical data

Electrical connection

Voltage	V	110
Phase	~	1
Frequency	Hz	60
Protection class		IPX4
Protection category		I

Performance data

Heating capacity	W	1600
Maximum operating pressure	MPa	0.35
Heating-up time	Seconds	30
Continuous steaming	g/min	40
Maximum steam blast	g/min	100

Filling quantity

Water reservoir	l	1.0
-----------------	---	-----

Dimensions and weights

Weight (without accessories)	kg	3.2
Length	mm	360
Width	mm	236
Height	mm	252

Subject to technical modifications.

家用多功能快拆式 EasyFix 高壓高溫蒸氣清洗機 SC 3 (黃) / SC 3 頂級款 (白)

(一) 主機準備

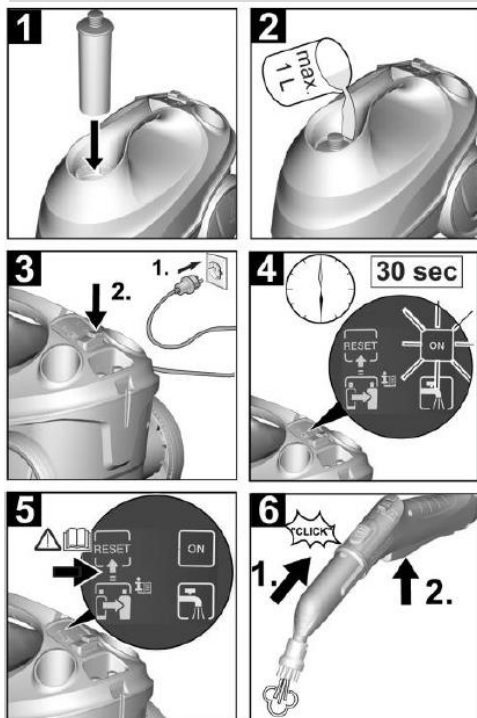

圖示 1、請將除鈣過濾桶如上圖方向插入主機上端加水口。

圖示 2、加入約一公升。

圖示 3、將電源線插入 110V 電源插座上後，按下電源開關。

圖示 5、第一次使用時請先依照您所在區域水質設定除鈣功能。

圖示 4、當蒸氣加熱狀態燈顯示綠色時，等待 30 秒後即可開始使用。

圖示 6、安全鎖上鎖後接上配件，解鎖開始用。

注意

您將在接下來的說明中依圖表內水質進行設定或調整除鈣功能。

(二) 設定/調整除鈣過濾功能

注意

- 當主機加入自來水後並按下電源開關後，除鈣過濾桶功能才會啟用。
- 水裡的石灰將會由除鈣過濾器中的除鈣顆粒吸收與過濾。延長主機使用壽命與正常加熱。
- 除鈣過濾桶內的顆粒不會對主機或任何設備有任何損害或化學影響。

水質硬度等級	硬度	濃度	閃爍次數	間隔秒數	
I	軟	0-7	0-1.3	1x	4 秒
II	中等	7-14	1.3-2.5	2x	
III	硬	14-21	2.5-3.8	3x	
IV	非常硬	>21	>3.8	4x	

為了要讓除鈣有最佳的效果，第一次使用請依照當地水質硬度進行調整。有關於您所在區域的水質請參考台灣自來水公司網站或免費服務專線：1910 (台北市請撥 02-89780837)

請按照以下的設定步驟操作：

- 將電源線插頭插於電源插座上。
- 按下 Reset 鍵並按住不放。
- 按下主機電源。
(若沒有出現燈號閃爍，請重新開關主機電源)再重複上述動作。
- 約 2 秒後主機狀態燈閃爍，並閃爍顯示目前主機除鈣功能設定值。
- 放開 Reset 鍵。
- 依照水質硬度等級，再按下 Reset 鍵，除鈣功能設定值將會改變。
- 按下 Reset 鍵並不會儲存設定。
- 依照上表閃爍次數選擇到您對應的水

值等級後持續按住 Reset 鍵 3 秒儲存設定。當您使用本主機在不同區域時，並須重新設定除鈣功能。

(三) 安全提示

▲危險

1. 嚴禁在具有可能會引爆物品區域使用。
2. 如要在具有化學混合物區域使用請注意使用安全。
3. 嚴禁使用任何清潔劑、化學藥劑與香精油添加至主機水箱內。
4. 本主機不能使用在任何電器清潔，例如電視、燈具、吹風機或電熱器等可能會讓蒸氣影響電器內電路板設備損壞。
5. 請確實依照說明提示操作主機，在之前請勿任意操作使用。另外請確實確認電源線是否有鬆脫，及安全開關、蒸氣軟管是否有異常或破損。
6. 如果電源線有出現異常軟化或鬆脫時，請立刻停止使用並連絡德國凱馳授權經銷商或技術服務維修中心更換或維修。
7. 如果蒸氣軟管有破裂或損壞，請立刻停止使用並連絡德國凱馳授權經銷商或技術服務維修中心更換或維修。
8. 請勿濕手碰觸電源插頭。
9. 請勿使用主機清潔一些具有化學成份的物體。
10. 蒸氣噴口具備高達95度以上的溫度，請勿在操作時近距離接觸蒸氣噴口，以免燙傷。
11. 請確認使用適當的電壓。
12. 在潮濕的區域如廁所使用時，請注意電源裝置是否有機會接觸到潮濕水源，以免觸電。
13. 請勿將電源線放在水裡。
14. 請確認電源線及電源接口是否有任何異常，請立刻停止使用並連絡德國凱馳授權經銷商或技術服務維修中心更換。

15. 請確實按照說明書內步驟安全使用主機，如有孩童或使用者需協助時，請安排他人協助指導操作，並在正確的操作方式進行清潔。
16. 電源線請勿任意擺放存放，請確實收納。
17. 請勿使用任何清潔劑或具備酸性物質的清潔劑清潔主機以免損害主機使用。
18. 請勿將主機放置於室外。
19. 使用主機時，請注意附近是否有孩童或任何可能會造成傷害的物體。
20. 更換各類噴頭前，請確實將安全保護開關鎖上，以免被高壓蒸氣燙傷。
21. 請勿將噴頭朝向自己或別人。
22. 請勿任意拆解主機，非授權或使用非原廠配件會造成主機保固喪失。
23. 使用延長線，請注意延長線最高負載功率是否可以負荷本主機使用中功率，或選購兩平方米延長線。

(四) 主機配件安裝及操作

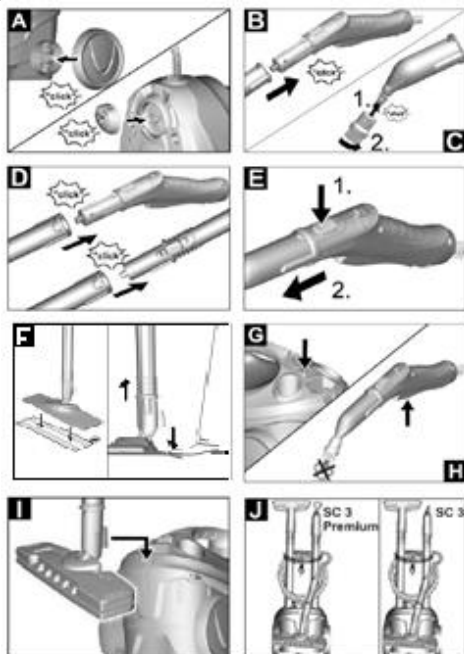

配件	料號
圓刷組 (黑 x2 / 黃 x2)	2.863-264.0
玻璃刮刀刷	2.863-025.0
超細纖維大圓刷布套	2.863-243.0
大圓刷	2.863-022.0
蒸氣振動角度噴頭	2.863-159.0
蒸氣掛邊刷	2.863-233.0
快拆式超細纖維地板刷布巾組	2.863-259.0

安裝配件圖示 A~J

- A、將主機側輪與前多向滾輪安裝於主機側邊並聽到「喀」表示固定完成。
- B/C、將需要搭配的配件組裝於槍把上，安裝連結後聽到「喀」或旋緊表示已經完全連接固定。
- D、安裝延長桿時，請依照圖示箭頭方向連結並聽到「喀」一聲固定。
- E、移除噴頭或延長桿時，請下壓連接扣鎖後再移除配件。
- F、清潔前請先將附贈的快拆式超細纖維地板布巾或手持刷布套沾濕後與刷頭相互黏合。
- G/H、關閉主機，請依照圖示先將電源插頭拔下後，鎖上安全保護開關。
- I、將地板刷頭掛於主機後的掛架。
- J、收納主機，請將高壓蒸氣軟管依圖示收納即可。

(五) 相關配件

全系列德國凱馳產品皆有專用相關的配件進行更換或維修，請勿任意拆解，此動作很有可能讓主機損壞且無法修復。相關配件購買，請

洽德國凱馳原廠展售中心或授權經銷商。

(六) 主機配件與外觀介紹

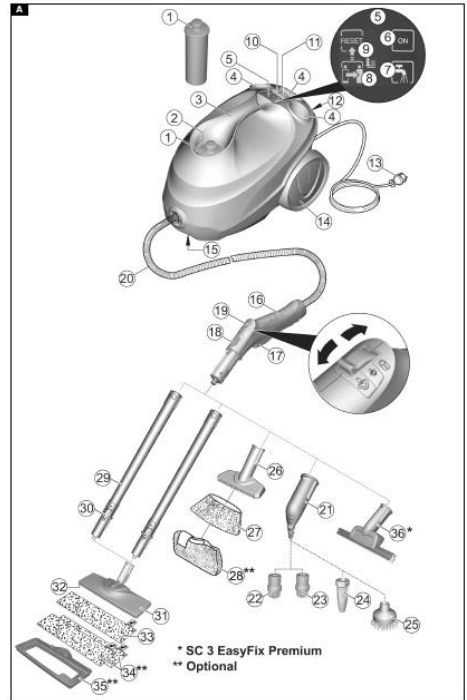

* SC 3 EasyFix Premium 標配 **選購配件

- 1 除鈣過濾桶
- 2 自來水加水口
- 3 主機把手
- 4 配件收納座
- 5 主機狀態燈
- 6 狀態燈-(綠)-電源開啟
- 7 狀態燈-(紅)-水量不足
- 8 狀態燈-(紅)-更換除鈣過濾桶
- 9 重設按鍵-設定水質硬度功能
- 10 電源開關-ON

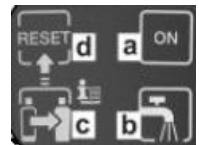

- 11 電源開關-OFF
- 12 地板刷掛架
- 13 電源線組含電源插頭
- 14 滾輪 x 2
- 15 前多向滾輪
- 16 蒸氣噴槍
- 17 高壓蒸氣開關
- 18 噴槍配件連結固定按鍵
- 19 調整蒸氣量含兒童安全鎖
- 20 高壓蒸氣軟管
- 21 細微噴頭
- 22 小圓刷(黑)(適用於刷洗表面污垢)
- 23 小圓刷(黃)(適用於刷洗表面污垢)
- 24 強力噴頭 (適用細縫邊角污垢)
- 25 大圓刷 (適用大面積表面刷洗)
- 26 手持刷(適用於家具飾品)
- 27 超細纖維手持刷布套
- 28 廚房浴室專用手持刷布套**
- 29 延長噴桿 x 2
- 30 連接扣鎖
- 31 快拆式地板刷(適用於地板清潔)
- 32 塑膠魔鬼粘鈎
- 33 快拆式超細纖維地板刷布巾 x 1
- 34 快拆式超細纖維地板刷布巾 x 2**
- 35 地毯專用地板刷蓋**
- 36 玻璃刮刀刷*

(七) 加入自來水

自來水可在主機使用中任何時間加入。嚴禁使用凝結水、純水或添加任何化學成分的清潔劑、芳香劑或使用電解水。

→ 加入最多一公升的自來水。

(八) 開啟主機使用

注意

1. 請依照前步驟確實安裝除鈣過濾桶以確保最佳清潔效果。
2. 使用高壓蒸氣時請勿移除除鈣過濾桶，以免主機受損。
3. 如果在主機啟動中將除鈣過濾桶移除，必須重新設定除鈣過濾(請參照第二項說明)

→ 將主機平放於平坦的地面。

→ 將電源電插頭插於插座。

→ 按下 ON 電源開關

→ 主機狀態燈顯示綠燈

→ 綠燈顯示後等待 30 秒再使用。

注意

主機發出噪音聲為馬達正在補水至電加熱裝置為正常狀態。

(九) 調整高壓蒸氣量

可以利用蒸氣手把上的三段控制開關調整蒸氣釋放量。



最大蒸氣量



最小蒸氣量



安全開關(注意調整至此時，蒸氣手把上的開關將無法按壓)

(十) 臨時中斷清潔

如果臨時中斷清潔時間超過 20 分鐘時請關閉主機省電節能。

→ 按下 OFF 電源開關關閉主機。

(十一) 關閉主機

→ 關閉主機，請依照前圖示 G/H 先將電源開關關閉後拔下插頭，鎖上兒童安全保護開關。

注意

如果主機會有兩個月時間不會使用請將主機內剩餘的自來水倒除防止水垢發生。

(十二) 更換新的除鈣過濾桶

注意

當更換除鈣過濾桶燈號亮起時，請聯繫德國凱馳直營服務中心或授權經銷經訂購新的除鈣過濾桶(料號：2.863-018.0)。

- 主機剩下兩小時工作時間前，更換燈號將閃爍。
- 主機剩下一小時工作時間前，更換燈號快速閃爍。
- 需要更換時，更換燈號持續亮起，主機電源自動關閉。

- 關閉主機開關。
- 將除鈣過濾桶拿起。
- 安裝新的除鈣過濾桶。
- 開啟主機開關。
- 按住 Reset 鍵 4 秒。

此時主機狀態燈中的更換除鈣過濾燈將會熄滅，使用時間將重新計算。

- 讓主機重新加熱。
- 壓住高壓蒸氣開關約 30 秒。

提醒

當更新或第一次使用除鈣過濾桶後，主機需要一些時間加熱。您會覺得高壓蒸氣變小或斷斷續續釋出蒸氣，這都是正常的現象。

(十三) 主機收納

注意

請選擇適當的擺放位置及收納處負載重量。主機必須收納存放於室內。

(十四) 產品保固

1. 機器在正常狀態使用下，本公司針對主機電加熱裝置保固一年，其餘配件及消耗品，皆不在保固範圍內。
2. 德國凱馳建議本主機僅能使用於家用用途。主機若經原廠維修判斷為人為使用不當因素(如使用在商業營業用)，主機與其配件將失去原廠保固。
3. 主機僅能使用自來水。
4. 主機電加熱裝置與配件因原廠製造瑕疵將提供原廠零件維修。

(十五) 疑難排除

主機狀態燈-水量不足紅燈持續恆亮

→ 請添加自來水。

主機狀態燈-水量不足紅燈閃爍

乾燒保護已經啟動

→ 關閉與啟動主機電源。

→ 請確定除鈣過濾桶安裝正確與水量足夠。

沒有高壓蒸氣釋出或僅有一點蒸氣

→ 確定除鈣過濾桶安裝固定緊密。

→ 加水時讓不要移除除鈣過濾桶。

高壓蒸氣開關無法按壓

→ 槍把上的三段開關可能設定為安全鎖
主機狀態燈-更換除鈣過濾桶紅燈恆亮或閃爍。

主機在清潔工作時間自動結束

→ 更新新的除鈣過濾桶。請參考前章節。
Reset 鍵在更換新的除鈣過濾桶後忘了重新設定。

→ 按住 Reset 鍵 4 秒。

主機自動關閉，因為主機可工作時間已經

使用完畢

→ 請更換新的除鈣過濾桶。

Reset 鍵在更換除鈣過濾桶後未按壓

→ 請於更換後按住 Reset 鍵 4 秒。

產品規格表：

電壓	110 V / 60 Hz
消耗功率	1600 W
蒸氣壓力	3.5 Bar
加熱時間	約 30 秒
蒸氣量	40g / 每分鐘
體積 mm	360 x 236 x 252
重量(不含配件)	3.2 Kg
水箱容量	1 L

KÄRCHER

德國凱馳

德商 凱馳清潔設備股份有限公司

KÄRCHER LIMITED TAIWAN

235 新北市中和區員山路502號1F/2F-1

TEL: 02-2221-0698 FAX: 02-2221-1695

407 台中市西屯區甘肅路2段30號

TEL: 04-2317-6060 FAX: 04-2317-2050

807 高雄市鳳山區文安街15號

TEL: 07-780-3322 FAX: 07-780-3391

網址 WWW.KARCHER.COM.TW

免費服務專線 0800-666-825

SC 3 EasyFix 2020 V1



www.kaercher.com/dealersearch

Alfred Kärcher SE & Co. KG
Alfred-Kärcher-Str. 28-40
71364 Winnenden (Germany)
Tel.: +49 7195 14-0
Fax: +49 7195 14-2212

